

Habito®

Part of a new generation of products specially designed to allow you to style your living space in a fast and functional way.



LEADER
SGBP 4487

Habito® boards are strong and durable, with good sound insulation qualities, and are more user-friendly than traditional walls. They are the ideal way to adapt living spaces to current and future needs.

Habito® gives you the flexibility to restyle or renovate rooms or even redesign your entire home. The unique composition of the plaster core gives Habito® their exceptional qualities, allowing objects weighing up to 30kg to be hung from a simple chipboard screw with a diameter of 5mm.

CHARACTERISTICS

High-performance gypsum plasterboard with a unique plaster core giving its exceptional qualities. Achieves a severe duty rating in a single board partition system and satisfies BS 5234: Part 2 for strength and robustness requirements.

RECOMMENDED USE

Suitable for applications where fire, structural and acoustic levels are specified and designed for direct decoration.

PRODUCT FORMAT

Thickness	12.5mm
Nominal Weight	12.45kg/m ²
Nominal Sheet Size	1200mm x 2400mm
Edge Type	Recessed Edge 

FIRE RATING

- Non-combustible in accordance to BS 476: Part 4
- Low fire propagation in accordance to BS 476: Part 6
- Class 1 surface spread of flame in accordance to BS 476: Part 7
- Classified as Class 0 material in accordance to BS 476: Part 6 & 7
- Complete GypWall system providing up to 1 hour fire rating in accordance to BS 476: Part 22

MANUFACTURING SPECIFICATIONS

- In compliance with BS EN 520

EXTREME SHOCK-RESISTANCE

Thanks to the solid core, Habito® gypsum plasterboards are up to five times stronger than regular boards and are more resistant to repeated impacts from children playing, moving furniture, and everyday wear and tear.

SOUND INSULATION

Partition walls made with Habito® together with metal stud sections and mineral wool reduce noise from adjacent rooms.

EASY TO INSTALL

Habito® can be handled in the same way as standard boards. Despite the specially strong plaster core, Habito® is easy to trim - simply cut into the board with a safety cutter and apply pressure to break it in two, just like you would with a regular plasterboard. The recommended score and snap size is 15 cm.



ROBUSTNESS



FIXING CAPABILITY



FIXING STRENGTH



FIRE PROTECTION



ECO FRIENDLY



PRODUCTIVITY GAIN



STABILITY



RECYCLING CERTIFIED



SMOOTH MANUAL FINISH



INSPIRING SPACES



AESTHETIC & DESIGN



Gyproc ROBUST Wall System

Gyproc ROBUST Wall System is a specially designed, impact-resistant partition system that offers a superior performance alternative to traditional brick walls. The highly durable internal partition system is ideal for homes and high-traffic commercial areas where strong and robust walls are required.

IMPORTANT

Always use No. 10 wood screw to mount Habito® gypsum plasterboard. Use a cordless electric screwdriver that operates at no more than 500 revs per minute. Maximum weight per one fixing point is 30 kg.

TIPS

- Always use coarse-thread screws with a diameter depending on the object.
- Screw threads must always run all the way up to the head.
- No special tools or plugs are needed; simply secure the screw in the board with a crosshead screwdriver.
- Always follow the manufacturer's instructions when mounting objects. For example, if a TV plus wall bracket weighs 20kg and the bracket should be fixed to the wall at four points, you must use four screws, even though the load-bearing capacity is 120kg.
- When choosing the screw length, always consider any piping or cables running behind the wall.

HEALTH AND ENVIRONMENTAL CONTRIBUTIONS

- Made from 100% natural gypsum
- Recyclable material, environmentally friendly
- Green-labelled product endorsed by the Singapore Green Building Council
- Does not produce toxic fumes or hazardous substances that are harmful to health

QUALITY ASSURANCE

- Product is manufactured in a facility certified to ISO 14001, ISO 45001, ISO 9001

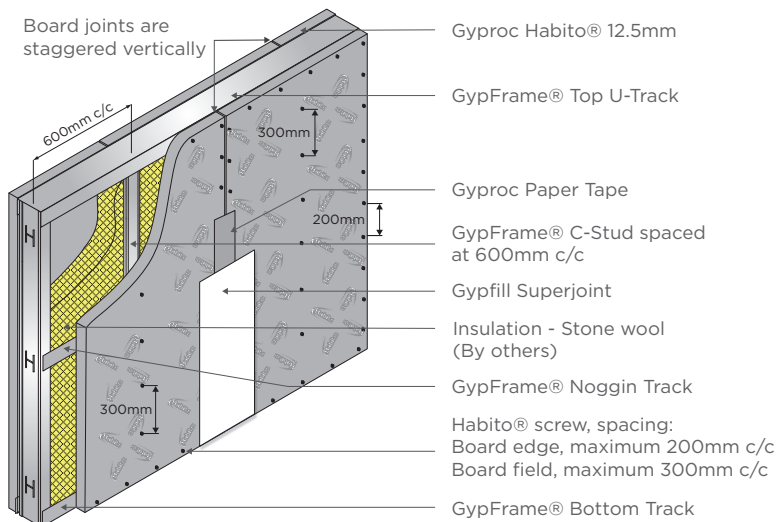

GypWall® ROBUST

Parameters	Values
Duty Rating (BS 5234: Part 2)	Severe
Fire Rating (BS 476: Part 22)	1 Hour

Disclaimer:
The images provided are for reference only. Kindly obtain confirmation from Gyproc's Technical Support Personnel before submission of specification for any project. The information in this literature is accurate at the time of publishing. The publisher reserves all rights to revise the product specifications without prior notice. It is the user's responsibility to ensure that the information communicated here is current before use and that the information provided here is for guidance only. Users must ensure that they are fully conversant with the products and systems before specification or installation.



SAINT-GOBAIN MALAYSIA SDN. BHD. (636775-T)
No 1 Jalan Sultan Mohamad 4,
Kawasan Perindustrian Bandar Sultan Suleiman,
42000 Port Klang, Selangor D E, Malaysia.
+603 3169 5588 +603 3169 5688
www.saint-gobain.my



SAINT-GOBAIN (SINGAPORE) PTE. LTD.
2 Venture Drive,
#13-18 Vision Exchange,
Singapore 608526.
+65 6330 8288 +65 6330 8289
www.saint-gobain.sg

