

weberdry FLEXI coat

High Performance Seamless Acrylic Waterproofing

weberdry FLEXI coat is a single component, UV-resistant, liquid applied, seamless acrylic waterproofing membrane. It has excellent weather resistance & UV-resistance, making it suitable to be used on exposed surfaces.



PRODUCT BENEFITS



UV
RESISTANT

USES

- RC Roofs
- RC Gutters
- Balconies
- Metal Roofs
- Terraces
- A/C Ledge
- External wall
- Cementitious substrates
- Gutter / Downpipes

TECHNICAL DATA & PHYSICAL PROPERTIES

Colour	Grey / White
Density	1.8kg / l at +23°C
Shelf Life	12 months from date of production
Service Temperature	Between 5°C to 40°C (improved system)
Storage Temperature	Between 5°C to 40°C
Substrate Temperature	5°C - 35°C
Substrate coated	No standing water/condensation on the substrate to be coated
Air Humidity	Maximum 80%
Dew point	Surface temperature must be +3°C above the dew point
1st coat to primer	1 - 2 hours
Over Coat Time	4 - 6 hours
Final coat	12 - 24 hours to reinforcement
Curing Time	48 hours
Standard System	
Priming Coat	0.4kg/m ² (Dilute the product with 10% of clean potable water)
1st Coat	0.5 kg/m ²
Final Coat	0.5 kg/m ²
Improved System	
Priming Coat	0.4 kg/m ² (Dilute the product with 10% of clean potable water)
1st Coat	0.5 kg/m ²
Reinforcement	0.5 kg/m ² + 1 layer tape fibermesh 100
Final Coat	0.5 kg/m ²
Tensile Adhesion Strength	≈ 1.0 N/mm ²
ASTM D7234	
Elongation at break	> 300%
ASTM D412	

weberdry FLEXI coat

High Performance Seamless Acrylic Waterproofing

FEATURES AND BENEFITS

- Eco-friendly with a low VOC.
- UV-resistant specially designed for exposed waterproofing areas
- Ultra-high bonding and elastic properties designed for superior crack-bridging.
- Easy application to minimize on-site errors.
- Enhanced durability with a polyurethane modified formulation hence. increases the service life of the roof or structure.

PROCEDURE & APPLICATION



Surface Preparation

New concrete should be cured for at least 28 days and should have a pull off strength ≥ 1.5 N/mm². Cement or mineral based substrates must be prepared mechanically using abrasive blast cleaning or scarifying equipment to remove cement laitance and to achieve an open textured surface. Loose friable material and weak concrete must be completely removed and surface defects such as blowholes and voids must be fully exposed. Substrate must have sufficient a gradient for surface water to run off easily without any ponding water.

Constraints

Do not apply on substrates with rising moisture. Always apply during falling ambient and substrate temperature. If applied during rising temperatures pin holes may occur from rising air. Ensure that temperature does not drop below 8°C and that relative humidity does not exceed 80% until the membrane has fully cured. Ensure that the coating is thoroughly dry and free of pinholes before applying any top coat. Do not allow temporary ponding to remain between coats on any horizontal surfaces or until the final coating has totally cured. Brush or mop off any surface water during this time. Do not apply directly on insulation boards. Protect the waterproofing 48 hours after the final coat. Do not expose waterproofing for pro-long period of time. It is highly recommended to protect the waterproofing membrane with polystyrene or protection board before back filling. Minimum joint over lapping is 100mm.

Application

Prior the application of **weberdry FLEXI coat**, all corners or possible weak areas must be treated with application of **weberdry FLEXI coat** with **webertape fibermesh 100**.



Improved System

weberdry FLEXI coat is applied with the reinforcement of **webertape fibermesh 100** to enhance the waterproofing system

- Apply primer (~0.4 kg/m²) of **weberdry FLEXI coat** +10% water.
- Apply 1st coat (~0.5 kg/m²) of **weberdry FLEXI coat** after 1 – 2 hours of primer coat .
- Apply 2nd coat (~0.5 kg/m²) of **weberdry FLEXI coat** then roll in **webertape fibermesh 100** and ensure that there are no bubbles or creases. Overlapping of **webertape fibermesh 100** at minimum 5 cm. It is highly recommended to carry out just 1m² per time for a least experienced applicator. Apply 4 – 6 hours after 1st layer.
- Apply final coat (~0.5 kg/m²) of **weberdry FLEXI coat**. Rule of thumb is to have sufficient materials to embed **webertape fibermesh 100**. Surface should be smooth after application. Apply the final coat after 12 to 24 hours of the 2nd coat.

Standard System

weberdry FLEXI coat is applied without reinforcement

- Apply primer (~0.4kg/m²) of **weberdry FLEXI coat** +10% water.
- Apply 1st coat (~0.5kg/m²) of **weberdry FLEXI coat** with proper tools, apply 1 – 2 hours after primer coat.
- Apply final coat (~0.5kg/m²) of **weberdry FLEXI coat** after 4 – 6 hours of 1st coat

weberdry FLEXI coat

High Performance Seamless Acrylic Waterproofing

PROCEDURE & APPLICATION



Curing

The waterproofing must not become wet while it is still curing. It should be protected from direct sunlight, rain or pedestrian traffic 4 days of natural air curing is normally sufficient however 7 days is recommended for over coating with other cementitious materials such as screed and tile adhesive

Water ponding tests can be carried out after 4 days curing

COVERAGE

Improved system Approx. 10m² per 20kg plastic pail

Standard system Approx. 13m² per 20kg plastic pail

STORAGE & PACKING

5 & 20kg plastic pails

Shelf life of 12 months when stored in dry conditions of normal ambient temperature between 5°C to 35°C.

HEALTH & SAFETY

For information and advice on the safe handling, storage and disposal of chemical products, users shall refer to the most recent Safety Data Sheet containing physical, ecological, toxicological and other safety-related data

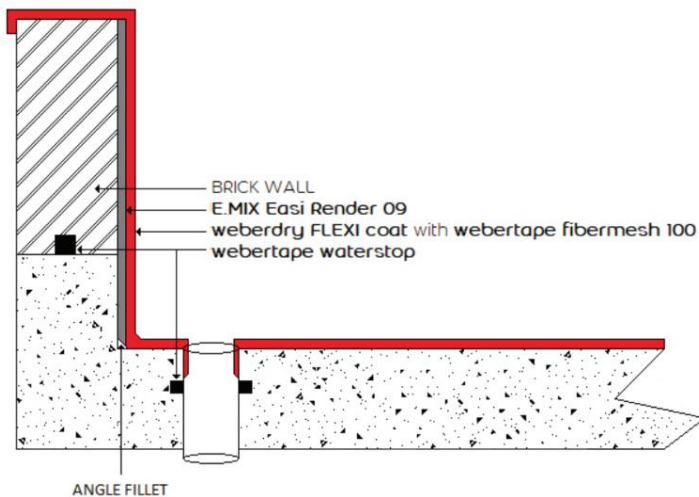

*Note Because it is not possible to give specific instructions for the various site conditions or to control the applications, the information on this Technical Data Sheet is for general guidance only. Saint-Gobain Weber (M) Sdn Bhd reserves the rights to amend the contents of the data sheet at its sole discretion. (Feb '24)



SAINT-GOBAIN WEBER (M) SDN BHD

No 29 & 31, Jalan TIAJ 2/1, Taman Industri Alam Jaya, 42300 Bandar Puncak Alam, Selangor D E, Malaysia



(603) 60389498/97/89



(603) 6038 9507



info.webermalaysia@saint-gobain.com



www.saint-gobain.my