



prima *drywall*

Features



prima drywall

IBS, Fast, Lightweight, Durable, Fire-Rated

prima drywall is a wall system which comprises of **primaliner™** fibre cement boards fixed onto galvanised steel stud and track frames that can be erected in a fully (100%) dry condition without the need for cement mortar plastering. **prima drywall** system's acoustic, heat and fire resistant standards can be improved by adding mineral wool as the insulation material; moreover the system is designed to meet the Malaysia Uniform Building By-Laws (UBBL) & BOMBA requirements.

prima drywall system is CIDB Industrialized Building System (IBS) certified and meets the stringent standards of both CONQUAS and QLASSIC while contributing to the Green Building Index (GBI) ratings. The advantages of **prima drywall** system particularly with the innovative, cost-efficient and hassle-free building system makes it one of the best methods of construction.

prima drywall system can be categorized into 4 groups:

- Category 1: **prima drywall** – General
- Category 2: **prima drywall** – Impact
- Category 3: **prima drywall** – Acoustic
- Category 4: **prima drywall** – Fire-Rated

Product Benefits

- Fire-Rated (BOMBA)
- Cost Effective
- Space Efficient
- CONQUAS & QLASSIC Standards
- Better Site Management, Low Wastage
- Fast & Lightweight (IBS)
- Simple Construction Method
- Solid, Strong & Secured (BS 5234, Part 2)
- High STC & Thermal Resistant
- No Stiffeners Required

** Please refer to Saint-Gobain Prima Technical Department for further design requirement*

Performance & Robustness

- IBS factor : 1.0
- Severe Duty (BS 5234: Part 2)
- Adhered to CONQUAS & QLASSIC surface evenness requirements
- Installation speed 5 times faster than brick wall

Recommended Applications

Fire-Rated

- General Fire-Rated Wall

Non Fire-Rated

- General Area
- Wet Area
- Internal & External Walls

prima drywall System Overview

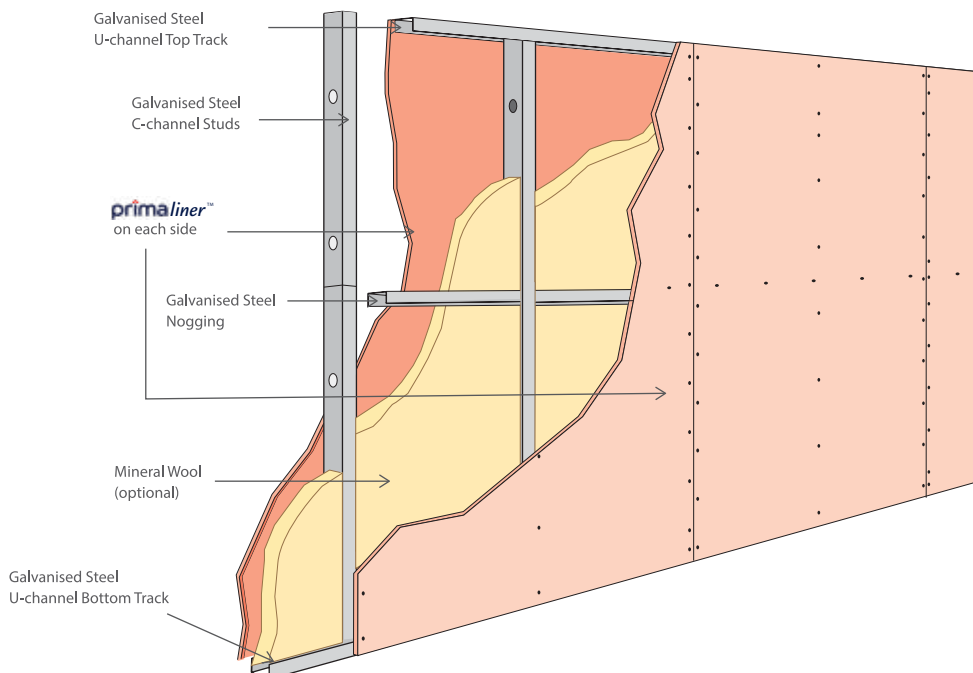

How to install **prima** drywall?

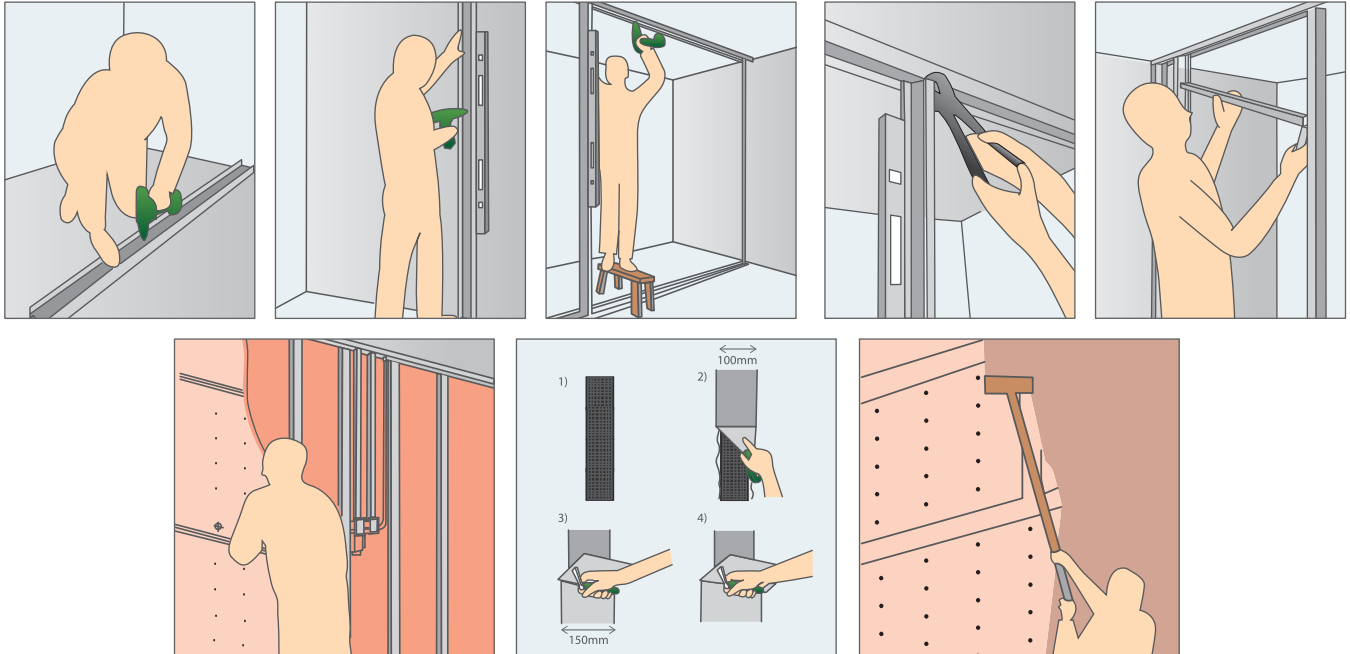

1. Set the wall position fix the soffit & floor tracks (U Tracks).
2. Fix the intermediate wall studs (C Stud).
3. Fix door frame & window frame.
4. Install the 1st layer of **primaliner™** board.
5. Fix M&E services.
6. Insert mineral wool (optional)
7. Insert 2nd layer of **primaliner™** board
8. Flush jointing & patching of fastener.
9. Finishes.

The wall is complete and ready for painting, texture coating, wallpaper or even tiling application.

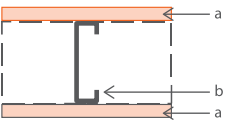
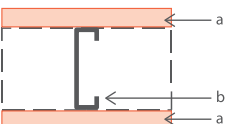

primadrywall - General

System Configuration	System ID	System Components	Stud Size	Nominal Wall Thickness	Nominal Wall Mass	Sound Transmission Class (STC)	Fire Resistance Period	Recommended
	G76L6	a) 6mm thick primaliner™ b) 0.55mm BMT light gauge zincalume / galvanized steel frame or equivalent	64mm	76mm	21.0kg/m ²	36dB	•	Internal Residential
	G88L6		76mm	88mm	21.1kg/m ²	37dB*	•	
	G104L6		92mm	104mm	21.3kg/m ²	37dB*	•	
	G112L6		100mm	112mm	21.4kg/m ²	37dB*	•	
	G82L9	a) 9mm thick primaliner™ b) 0.55mm BMT light gauge zincalume / galvanized steel frame or equivalent	64mm	82mm	30.0kg/m ²	41dB*	•	Internal Commercial
	G94L9		76mm	94mm	30.1kg/m ²	41dB*	•	
	G110L9		92mm	110mm	30.3kg/m ²	42dB*	•	
	G118L9		100mm	118mm	30.4kg/m ²	42dB*	•	

primadrywall - Impact

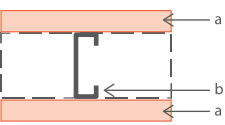
System Configuration	System ID	System Components	Stud Size	Nominal Wall Thickness	Nominal Wall Mass	Sound Transmission Class (STC)	Fire Resistance Period	Recommended
	I88L12	a) 12mm thick primaliner™ b) 0.50mm BMT light gauge zincalume / galvanized steel frame or equivalent	64mm	88mm	40.0kg/m ²	44dB*	•	Internal Commercial
	I100L12		76mm	100mm	40.1kg/m ²	44dB*	•	
	I116L12		92mm	116mm	40.3kg/m ²	45dB*	•	
	I124L12		100mm	124mm	40.4kg/m ²	46dB*	•	

primadrywall - Acoustic

System Configuration	System ID	System Components	Stud Size	Nominal Wall Thickness	Nominal Wall Mass	Sound Transmission Class (STC)	Fire Resistance Period	Recommended
	A76L6	a) 6mm thick primaliner™ b) 50mm thick mineral wool insulation @ 16kg/m ³ density c) 0.55mm BMT light gauge zincalume / galvanized steel frame or equivalent	64mm	76mm	22.0kg/m ²	41dB*	•	Internal Residential
	A112L6	a) 6mm thick primaliner™ b) 100mm thick mineral wool insulation @ 16kg/m ³ density c) 0.55mm BMT light gauge zincalume / galvanized steel frame or equivalent	100mm	112mm	22.4kg/m ²	47dB*	•	Internal Residential
	A82 L9	a) 9mm thick primaliner™ b) 50mm thick mineral wool insulation @ 16kg/m ³ density c) 0.55mm BMT light gauge zincalume / galvanized steel frame or equivalent	64mm	82mm	31.0kg/m ²	51dB*	•	Internal Commercial

Remark: * STC value predicted base on Marshellday Acoustic Software (Insul 7.0)

** Tested value from SIRIM Bhd.

System Components & Properties

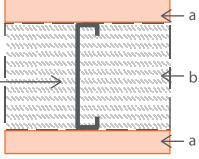
System Configuration	System ID	System Components	Stud Size	Nominal Wall Thickness	Nominal Wall Mass	Sound Transmission Class (STC)	Fire Resistance Period	Recommended
	A118 L9	a) 9mm thick primaliner™ b) 100mm thick mineral wool insulation @ 16kg/m ³ density c) 0.55mm BMT light gauge zinalume / galvanized steel frame or equivalent	100mm	118mm	33kg/m ²	53dB*	•	Internal Commercial

Remark: * STC value predicted base on Marshellday Acoustic Software (Insul 7.0)

** Tested value from SIRIM Bhd.

prima drywall - Fire-Rated

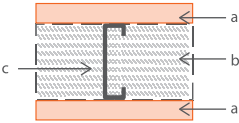
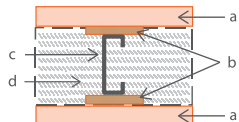
System Configuration	System ID	System Components	Stud Size	Nominal Wall Thickness	Nominal Wall Mass	Sound Transmission Class (STC)	Fire Resistance Period	Recommended
One Hour FRP (SIRIM) 	F94 L9	a) 9mm thick primaliner™ b) 75mm thick rockwool insulation @ 60kg/m ³ density. c) 0.55mm BMT light gauge zinalume / galvanized steel frame or equivalent	76mm	94mm	34kg/m ²	51dB* 50dB**	1 hour**	Internal Commercial
Two Hours FRP (SIRIM) 	F136 L12	a) 12mm thick primaliner™ b) 6mm x 100mm primaflex™ strip c) 100mm thick rockwool insulation @ 80kg/m ³ density. d) 0.55mm BMT light gauge zinalume / galvanized steel frame or equivalent	100mm	136mm	50kg/m ²	54dB* 53dB**	2 hours**	Internal Commercial

Remark: * STC value predicted base on Marshellday Acoustic Software (Insul 7.0)

** Tested value from SIRIM Bhd.



Framing

Framing member must be fabricated using light gauge galvanised coated (or equivalent) steel sections having a minimum of **0.55mm** base metal thickness with spacing not exceeding the following spacing distance:

- Wall studs - **610mm** c/c maximum
- Noggings - **1220mm** c/c maximum

The actual studs and noggings sizes shall be selected based on the above table. A fire rating or (and) sound insulation is required, refer to "System Components & Properties" table for additional requirements.

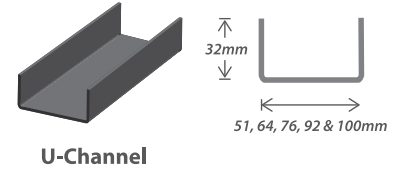
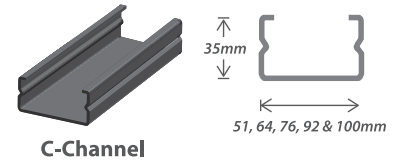

Sheet Installation & Fastening requirement

In drywall construction, **prima liner™** can be installed horizontally or vertically. The sheets must be laid staggered and ensure the sheet joints on one side of the wall do not coincide with the sheet joints on the other side of the wall.

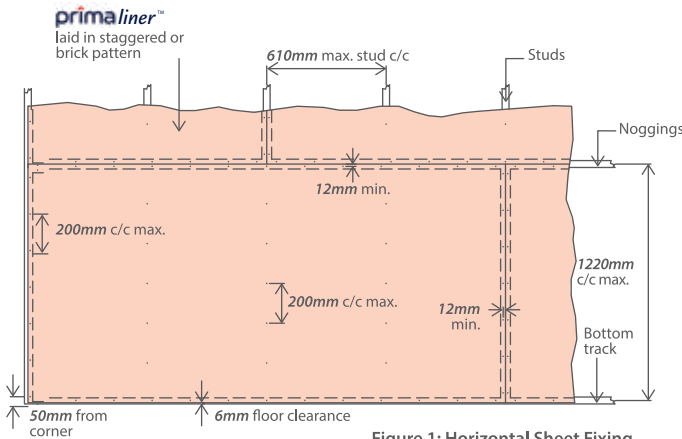

Figure 1: Horizontal Sheet Fixing

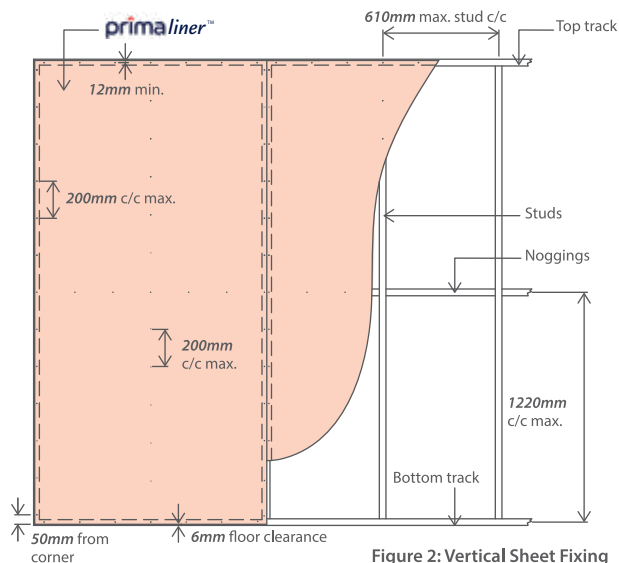

Figure 2: Vertical Sheet Fixing

Fastener Fixing Distance For Untiled Wall

- 12mm minimum from edges
- 50mm minimum from corners
- 200mm centres spacing along edges
- 200mm centres spacing elsewhere

Fastener Fixing Distance For Tiled Wall & Fire-Rated Wall

- 12mm minimum from edges
- 50mm minimum from corners
- 200mm centres spacing along edges
- 200mm centres spacing elsewhere

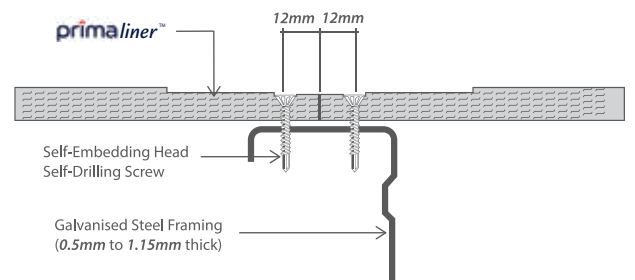

prima fastener - Wing Tek 25mm
Self-embedding head
wing tek screw



Applications:
4.5mm - 9.0mm board thickness

prima fastener - Wing Tek 35mm
Self-embedding head
wing tek screw



Applications:
12.0mm - 20.0mm board thickness

Joint Details

primaliner™ sheet joints can be treated as described in the **Figure 3**, incorporating Fibre Mesh Tape and Jointing Compound. The best result can be achieved when both **primaliner™** edges have recesses. Jointing non-recessed edges should be avoided.

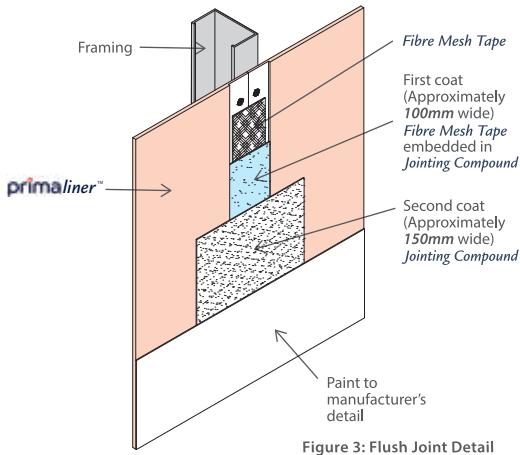

Figure 3: Flush Joint Detail

Expansion Joint

Expansion joints must be provided to accommodate anticipated movement within a building. **primadrywall** systems require expansion joints spacing to be located as follows:

Recommended Expansion Joints Spacing

Untiled walls	9.0m
Tiled walls	4.8m

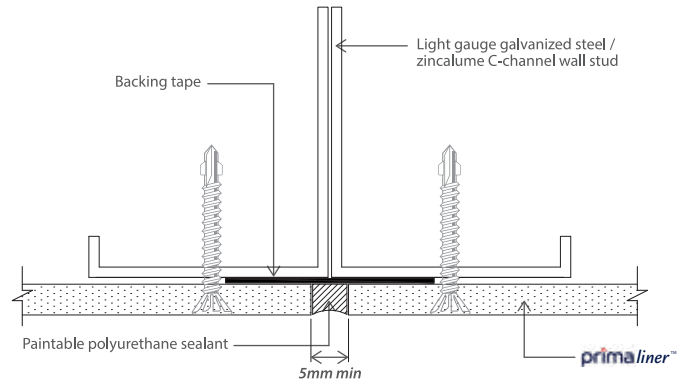

Figure 4: Vertical Control joint

Finishes

primaliner™ can be decorated with 2 coats of 100% quality water-based Acrylic Paint. For general-purpose applications, there is no requirement for Primers or Sealers. Alternatively, the sheet surface can be decorated with wall covering materials, such as Wallpaper. In all cases, coating manufacturer's recommendations must be strictly adhered to. For wet area application, water proofing and tile finishing may be preferred.

- The flexible Tile Adhesive shall comply to **AS 2358-1990**; Adhesive for ceramic wall tiles & mosaics.
- The choice of the Tile Adhesive varies, depending on the substrate and the type of tiles used. Refer to Tile Adhesive manufacturer for advice.
- DO NOT tile over the Expansion Joint.
- Expansion Joint should be sealed with flexible water-resistant Acrylic Sealant for general & wet area walls. Fire-rated seal is recommended for fire-rated walls.
- For wet area application, use cementitious Jointing Compound with alkaline-resistant fibre glass reinforcement tape to treat the sheet joints and finished with a layer of water-proofing coating on top before applying wall tiles.



Paint



Wall Covering



Texture Coating



Tiles

Accessories

primafastener - specially designed to work with Prima fibre cement boards. Comes in packing of 1000pcs per box.

primafastener - Wing Tek 25mm
Self-embedding head wing tek screw



Applications:
4.5mm - 9.0mm board thickness

primafastener - Wing Tek 35mm
Self-embedding head wing tek screw



Applications:
12.0mm - 20.0mm board thickness



CIDB MALAYSIA
A CIDB certified -
IBS status company



Termite Resistant



Fire Resistant



Water Resistant



Weather Resistant



100% Asbestos free



Superior Paint Adhesion



High Workability



Aesthetically Pleasing



50 Years Durability

For more information, please contact us at:



SAINT-GOBAIN PRIMA SDN BHD (579898-W)

Level 19, Tower 5, Avenue 7 The Horizon,
Bangsar South City, No. 8, Jalan Kerinchi,
59200 Kuala Lumpur, Malaysia

General Line 1: +603 7781 1977 | General Line 2: +6012 781 1797

www.primafibrecement.com | www.saint-gobain.my

[f](#) [in](#) [+](#) [@](#) [v](#) [saintgobainprima](#)